

SALF

Eccentric Locking Collar

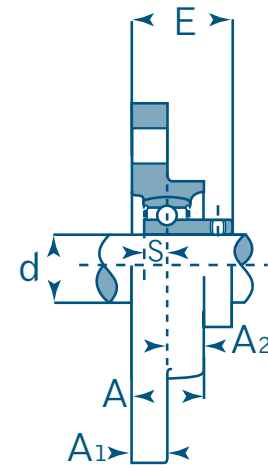

SBLF

Set Screw Locking

Unit No. SALF SBLF	Shaft Dia. Inch / mm d	Dimensions Inch / mm							SALF		SBLF		Bolt Size	Bearing No. SA / SB	Housing No.	Weight	
		H	J	L	A	A1	A2	N	S	E	S	E				kg	lbs
201 201-8 202 202-10 203 203-11	12 mm 1/2 15 mm 5/8 17 mm 11/16	3-3/16 81	2-1/2 63.5	2-7/32 56	23/32 18	3/8 9.5	3/8 9.5	5/16 8	0.2559 6.5	1.260 32	0.2362 6	1.000 25.5	1/4 M 6	201 201-8 202 202-10 203 203-11	LF 203	0.30	0.66
204 204-12	20 mm 3/4	3-17/32 90	2-13/16 71.5	2-13/32 61	25/32 20	7/16 11	7/16 11	13/32 10	0.2952 7.5	1.319 33.5	0.2755 7	1.142 29	5/16 M 8	204 204-12	LF 204	0.40	0.88
205 205-14 205-15 205-16	25 mm 7/8 15/16 1	3-3/4 95	2-33/32 76	2-17/32 64	25/32 20	7/16 11	7/16 11	13/32 10	0.2952 7.5	1.339 34	0.2952 7.5	1.200 30.5	5/16 M 8	205 205-14 205-15 205-16	LF 205	0.50	1.10
206 206-18 206-19 206-20	30 mm 1-1/8 1-3/16 1-1/4	4-7/16 113	3-9/16 90.5	3 76	7/8 22.5	15/32 12	15/32 12	15/32 12	0.3543 9	1.492 37.9	0.3149 8	1.338 34	3/8 M 10	206 206-18 206-19 206-20	LF 206	0.70	1.54
207 207-20 207-21 207-22 207-23	35 mm 1-1/4 1-5/16 1-3/8 1-7/16	4-13/16 122	3-15/16 100	3-1/2 89	15/16 24	33/64 13	33/64 13	15/32 12	0.3740 9.5	1.614 41	0.3346 8.5	1.437 36.5	3/8 M 10	207 207-20 207-21 207-22 207-23	LF 207	0.90	1.98

Add (G)suffix for regreasable. (ex. SALF 205-16G)