

### A 200

Unit No.	Shaft Dia. Inch / mm	Dimensions Inch / mm											Mass	
		d1	d2	B2	B3	H	r1	r2	G	F	S	ds	kg	lbs
A 201 201-8 202 202-10 203 203-11	12 mm 1/2 15 mm 5/8 17 mm 11/16	1.1260 28.6	0.8503 21.6	0.374 9.5	0.5315 13.5	0.0315 0.8	0.0157 0.4	0.0315 0.8	0.1969 5	0.1378 3.5	0.1969 5	1/4-28 UNF M6 x 1	0.05 0.05	0.11 0.11
A 204 204-12	20 mm 3/4	1.3110 33.3	1.0472 26.6	0.374 9.5	0.5315 13.5	0.0315 0.8	0.0157 0.4	0.0315 0.8	0.1969 5	0.1575 4	0.1969 5	1/4-28 UNF M6 x 1	0.06	0.14
A 205 205-14 205-15 205-16	25 mm 7/8 15/16 1	1.500 38.1	1.2441 31.6	0.374 9.5	0.5315 13.5	0.0315 0.8	0.0157 0.4	0.0315 0.8	0.1969 5	0.1575 4	0.1969 5	1/4-28 UNF M6 x 1	0.06 0.07 0.06 0.06	0.13 0.15 0.13 0.13
A 206 206-18 206-19 206-20	30 mm 1-1/8 1-3/16 1-1/4	1.7520 44.5	1.4921 37.9	0.4685 11.9	0.6260 15.9	0.0315 0.8	0.0157 0.4	0.0315 0.8	0.2362 6	0.1575 4	0.1969 5	1/4-28 UNF M6 x 1	0.10 0.10 0.10 0.09	0.22 0.22 0.22 0.20
A 207 207-20 207-21 207-22 207-23	35 mm 1-1/4 1-5/16 1-3/8 1-7/16	2.1890 55.6	1.7598 44.7	0.5315 13.5	0.6890 17.5	0.0315 0.8	0.0157 0.4	0.0315 0.8	0.2559 6.5	0.1969 5	0.2756 7	5/16-24 UNF M8 x 1	0.18 0.20 0.19 0.18 0.17	0.40 0.44 0.42 0.40 0.37
A 208 208-24 208-25	40 mm 1-1/2 1-9/16	2.3740 60.3	1.9449 49.4	0.5315 13.5	0.7205 18.3	0.0630 1.6	0.0157 0.4	0.0472 1.2	0.2559 6.5	0.1969 5	0.2756 7	5/16-24 UNF M8 x 1	0.21 0.20 0.21	0.46 0.44 0.46

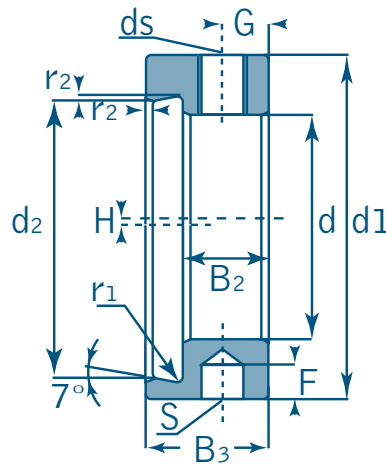

**A 200**

Unit No.	Shaft Dia. Inch / mm	Dimensions Inch / mm											Mass	
		d1	d2	B2	B3	H	r1	r2	G	F	S	ds	kg	lbs
A 209 209-26 209-27 209-28	45 mm 1-5/8 1-11/16 1-3/4	2.500 63.5	2.1417 54.4	0.5315 13.5	0.7205 18.3	0.0630 1.6	0.0157 0.4	0.0472 1.2	0.2559 6.5	0.1969 5	0.2756 7	5/16-24 UNF M8 x 1	0.22 0.25 0.22 0.22	0.48 0.55 0.48 0.48
A 210 210-30 210-31 210-32	50 mm 1-7/8 1-15/16 2	2.7520 69.9	2.3228 59	0.5315 13.5	0.7205 18.3	0.0630 1.6	0.0157 0.4	0.0472 1.2	0.2559 6.5	0.1969 5	0.2756 7	5/16-24 UNF M8 x 1	0.24 0.26 0.25	0.53 0.57 0.55
A 211 211-32 211-34 211-35	55 mm 2 2-1/8 2-3/16	3.000 76.2	2.5906 65.8	0.6260 15.9	0.8150 20.7	0.0630 1.6	0.0236 0.6	0.0472 1.2	0.3150 8	0.2362 6	0.3307 8.4	3/8-24 UNF M10 x 1.25	0.32 0.36 0.33 0.27	0.70 0.79 0.73 0.59
A 212 212-36 212-38 212-39	60 mm 2-1/4 2-3/8 2-7/16	3.3150 84.2	2.8228 71.7	0.6260 15.9	0.8780 22.3	0.0630 1.6	0.0236 0.6	0.0630 1.6	0.3150 8	0.2362 6	0.3307 8.4	3/8-24 UNF M10 x 1.25	0.41 0.44 0.41 0.38	0.90 0.97 0.90 0.84
A 213 213-40	65 mm 2-1/2	3.3858 86	3.1102 79	0.6890 17.5	0.9252 23.5	0.0630 1.6	0.0236 0.6	0.0630 1.6	0.3346 8.5	0.2362 6	0.3307 8.4	3/8-24 UNF M10 x 1.25	0.39 0.41	0.86 0.90
A 214 214-43 214-44	70 mm 2-11/16 2-3/4	3.8110 96.8	3.2795 83.3	0.6732 17.1	0.9252 23.5	0.0630 1.6	0.0236 0.6	0.0630 1.6	0.3346 8.5	0.2362 6	0.3465 8.8	3/8-24 UNF M10 x 1.25	0.40	0.88
A 215 215-47 215-48	75 mm 2-15/16 3	4.0157 102	3.4646 88	0.6890 17.5	0.9409 23.9	0.0630 1.6	0.0157 0.4	0.0630 1.6	0.3346 8.5	0.2362 6	0.3465 8.8	3/8-24 UNF M10 x 1.25	0.63 0.61	0.39 1.34
A 216 216-50	80 mm 3-1/8	4.3307 110	3.7244 94.6	0.8110 20.6	1.0630 27	0.0630 1.6	0.0157 0.4	0.0630 1.6	0.4055 10.3	0.2756 7	0.4252 10.8	7/16 -20 UNF M12 x 1.25		
A 217 217-52	85 mm 3-1/4	4.6850 119	3.9764 101	0.8110 20.6	1.0630 27	0.0630 1.6	0.0157 0.4	0.0630 1.6	0.4055 10.3	0.3150 8	0.4252 10.8	7/16 -20 UNF M12 x 1.25		
A 218 216-56	90 mm 3-1/2	4.7244 120	4.1535 105.5	0.6889 17.5	0.9448 24	0.9842 2.4	0.0157 0.4	0.0630 1.6	0.3740 9.5	0.3150 8	0.4252 10.8	7/16 -20 UNF M12 x 1.25		